

Installation instructions for 24.2947
Under Run Protective Shield Speed Sensor

TOYOTA Hilux



Hilux

Model year:

2015-

Applicability:

GUN125L-DTFSHW; GUN125L-DTFMHW
GUN126L-DTTMHW; GUN126L-DTTHHW

Part Number:

Steel: 24.2947



Weight:

Steel: 0.53 kg



Installation Time:

30 min

Rev.1 26.10.2015

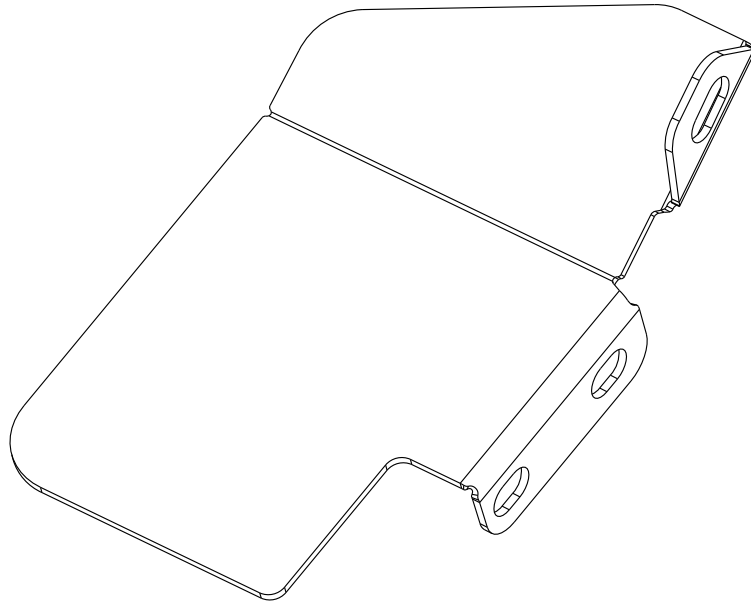
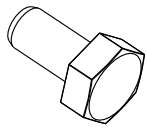
A**B**

M8x20

3x

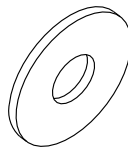
C

d=8

3x

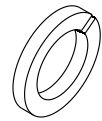
D

d=8

3x

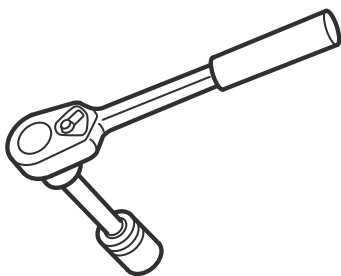

13 mm



1

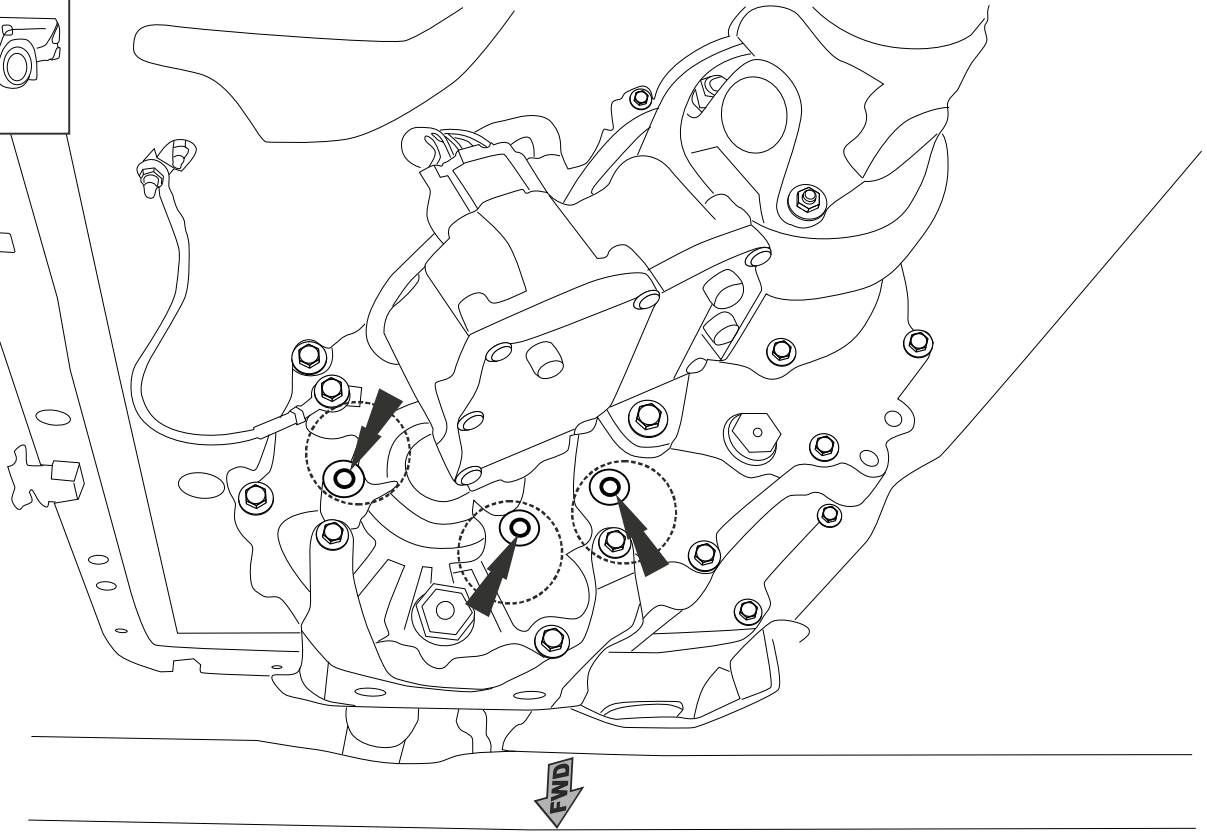
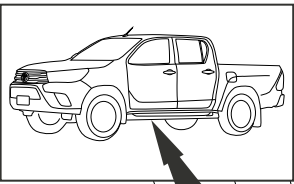

2

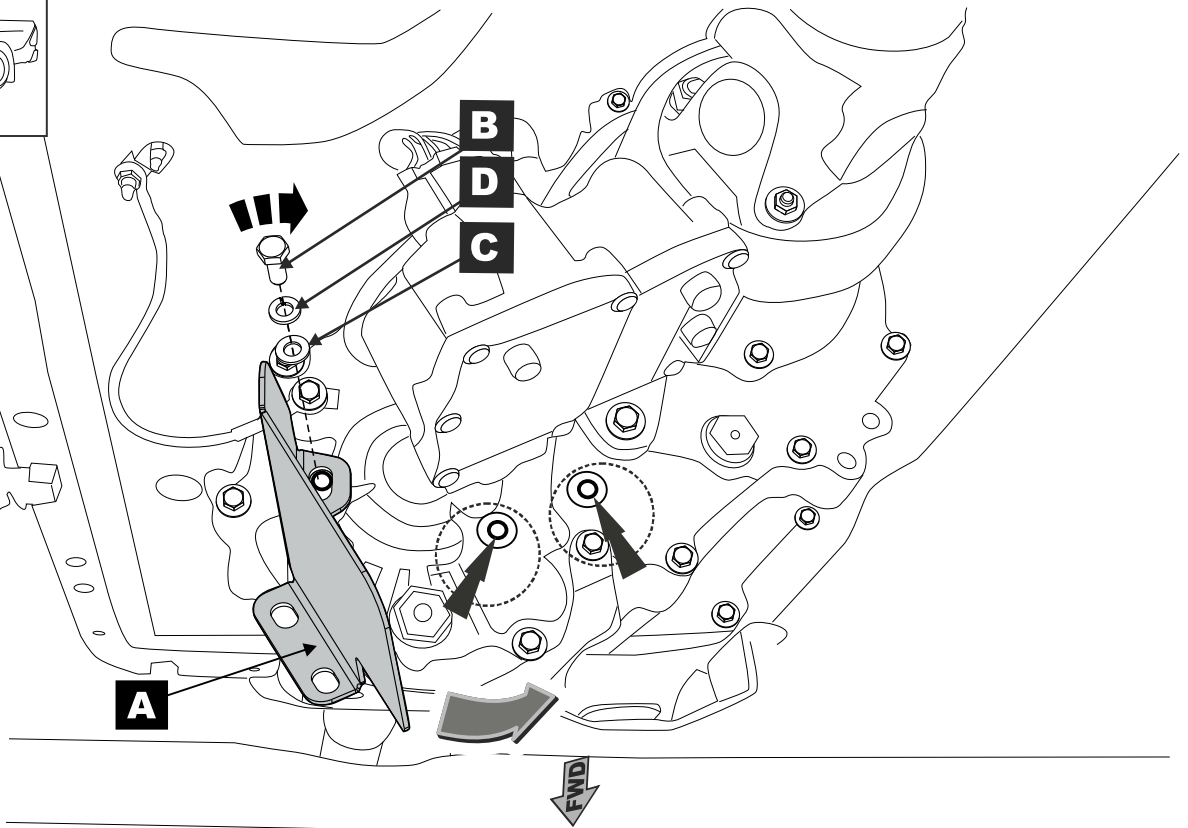
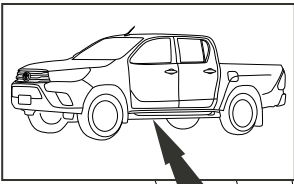

3

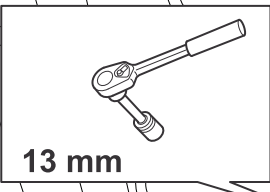
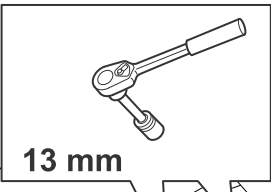
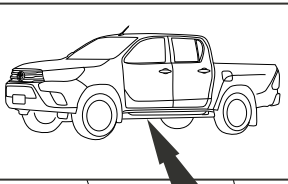

B
D
C

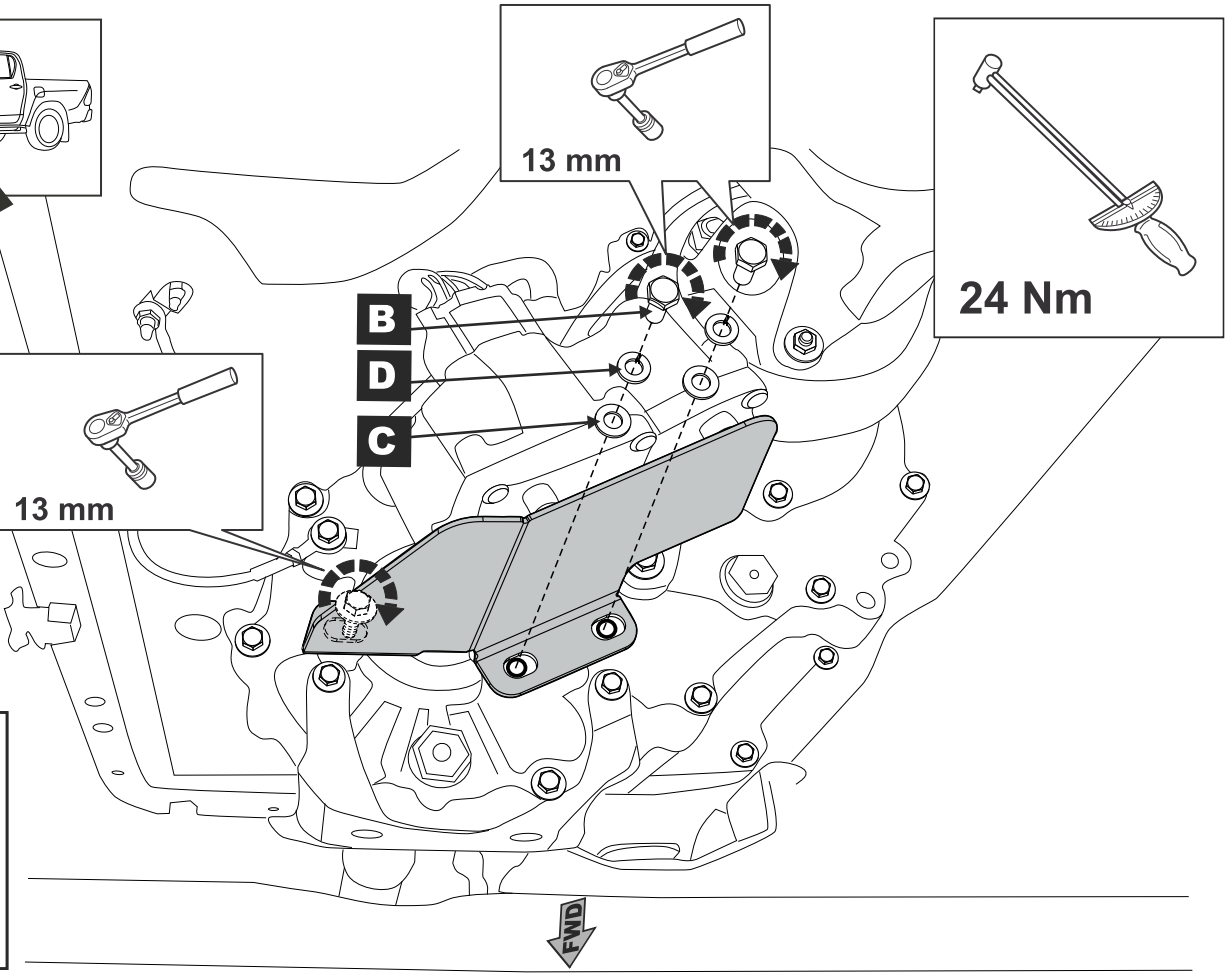

4

