

# Toyota Land Cruiser 75/78

- steering shafts skid plate for bumpers with winch

Body:

Years.: 2007- ;

V:

VIN:- JTFLB71J468012516

MT

Ref.: 24.1202

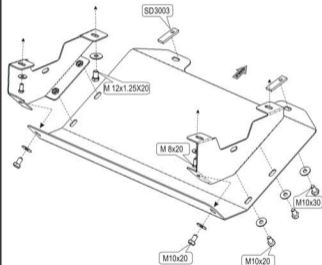

1. Disassemble the skid plate to component parts.
2. Remove OE duster.
3. Fix lateral protective wings to OE fixing points.
4. Fix the skid plate body to mounted wings and to bumper.
5. Tighten all screw joints.

