

Subaru Impreza

Body:
VIN:-

Years.: 2008- ;

V:
Type: 22.1274

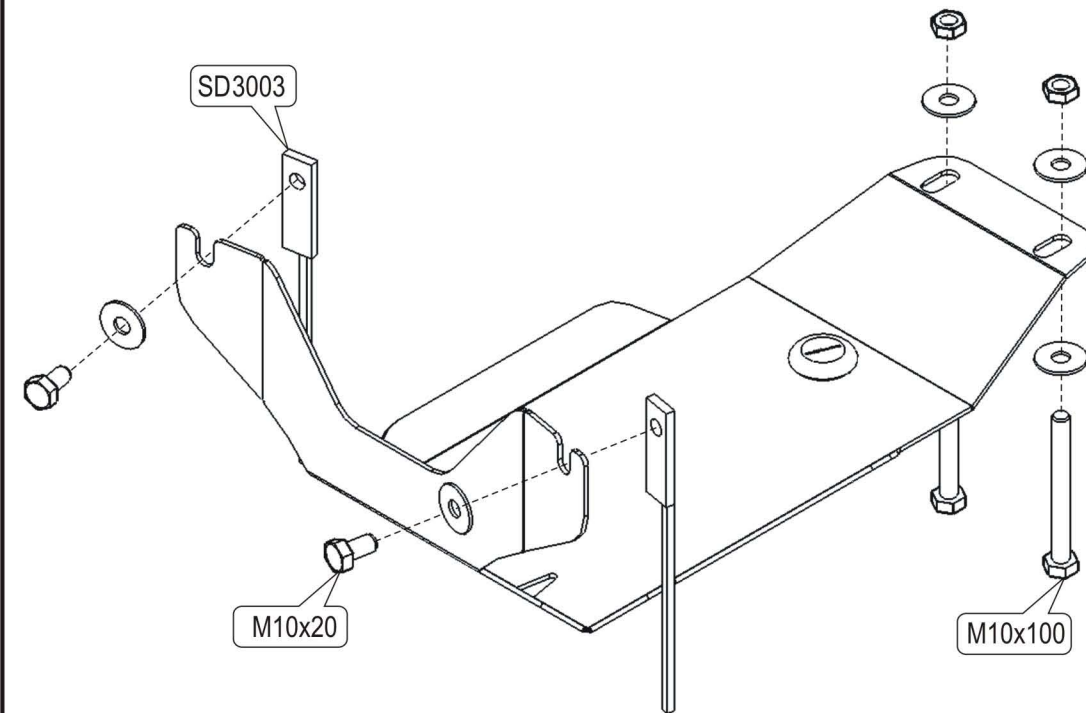

1. Fix the front part of the skid plate to OE aperures located on the reduction gearbox cover M 10x100.
2. Fix the rear part of the skid plate to reduction gearbox supporting beam with threaded inserts -SD 3003 and bolts M 10x20
3. Tighten all screw joints.

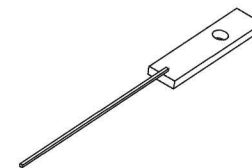

2 x -SD 3003



2 x Nut M10

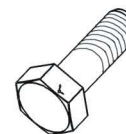

2 x M 10x20
2 x M 10x100



6 x 10