

Subaru Tribeca

Body:

Years.: 2005-;

V: ***

VIN:-

AT

Type: 22.784

Type: 22.785(AL)

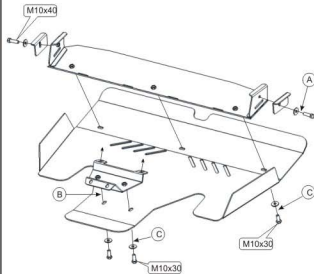

1. Remove regular plastic dust guard.
2. Disassemble the skid plate to component parts.
3. Fix the front frame to towing lugs -(A).
4. Remove regular reinforcer from the front axle beam and fix the rear frame instead of it -(B).
4. Fix the skid plate to already mounted elements-(C).
5. Tighten all screw joints

