

NISSAN TERRANO I

1986 - 1993

Type: 15.0278

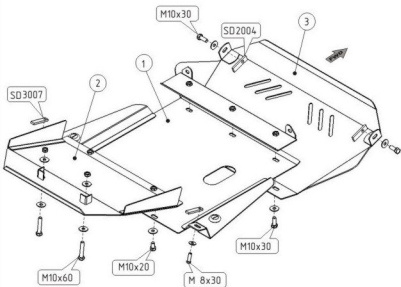

1. Disassemble the skid plate to component parts.
2. Fix the skid plate's beam to the front axle beam using OE bolts.
3. Fix element "1" to mounted beam in front and to the bearing elements of steering arms in rear.
4. Fix element "2" to element "1" in front and to transmission case supporting beam in rear.
5. Fix the front part element "3" to towing lugs, fix its rear part to the already mounted beam together with element "1".
6. Tighten all screw joints.

