

Mercedes W210

Body:
VIN:-

Years.: 1995 - 2001 ;

V: All except - 4wd

Type: 13.1169

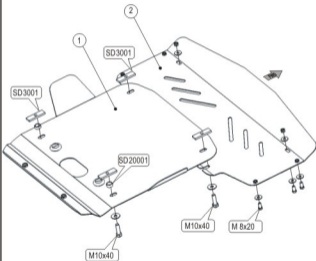

1. Remove OE plastic duster.
2. Disassemble the skid plate to component parts.
3. Fix threaded inserts to crossbars' apertures.
4. Fix element "1" to mounted threaded inserts. Do not tighten bolts yet.
5. Fix element "2" together with element "1" in rear and to the radiator's beam in front
6. Tighten all screw joints.
7. Mount lateral plastic wings.

