



JEEP Wrangler 2,0 AT AWD

2018 - 

SKID PLATE FOR TRANSMISSION CASE Installation Instructions

JEEP Wrangler

A1

Skid plate

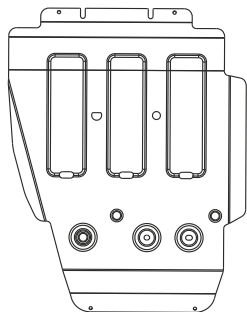

Main part

X1

A2

Skid plate

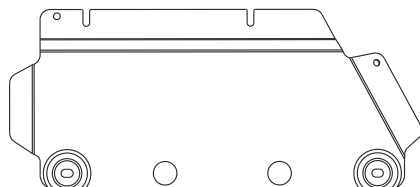

Main part

X1

B

Bracket

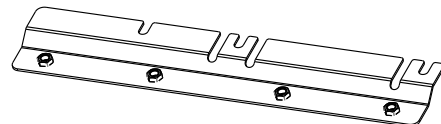

X1

C

ND 3009

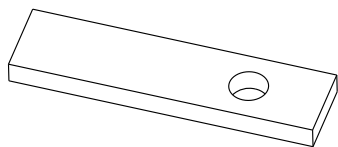

X2

D

M8 x 25 Bolt

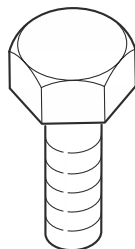

X2

E

M10 x 20 Bolt

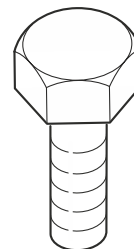

X4

F

M10 x 30 Bolt

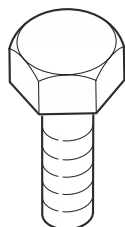

X2

G

Ø8 Washer

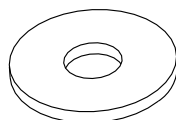

X2

H

Ø10 Washer

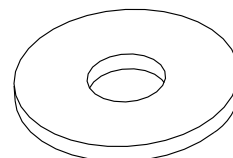

X6

Tools Required:

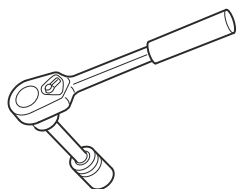

Ratchet with extension cord

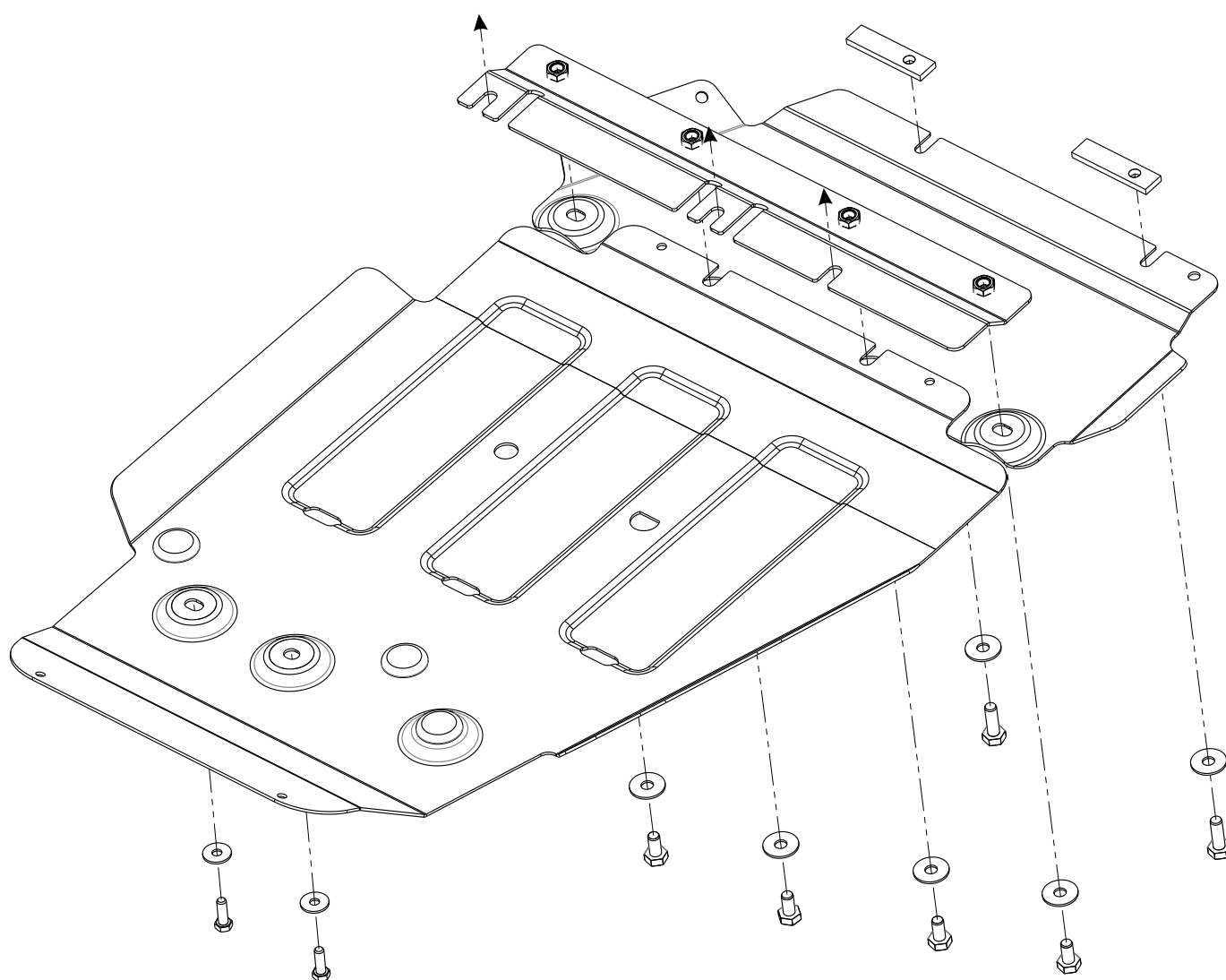

1

Install the bracket (B) on the standard holes in the crossbeam.
 Install the skid plate (A1) on the two center points of the bracket (B) and on the regular points of the rear crossbeam, using bolts M8x25 (D), M10x20 (E) and washers Ø8 (G), Ø10 (H).
 Insert NDs 3009 (C) into the front crossbeam.
 Set the skid plate (A2) on the last points of mounting the bracket (B) and on the NDs 3009 (C), using bolts M 10x30 (F), M10x20 (E) and washers Ø10 (H).
 Tighten all fastening points.

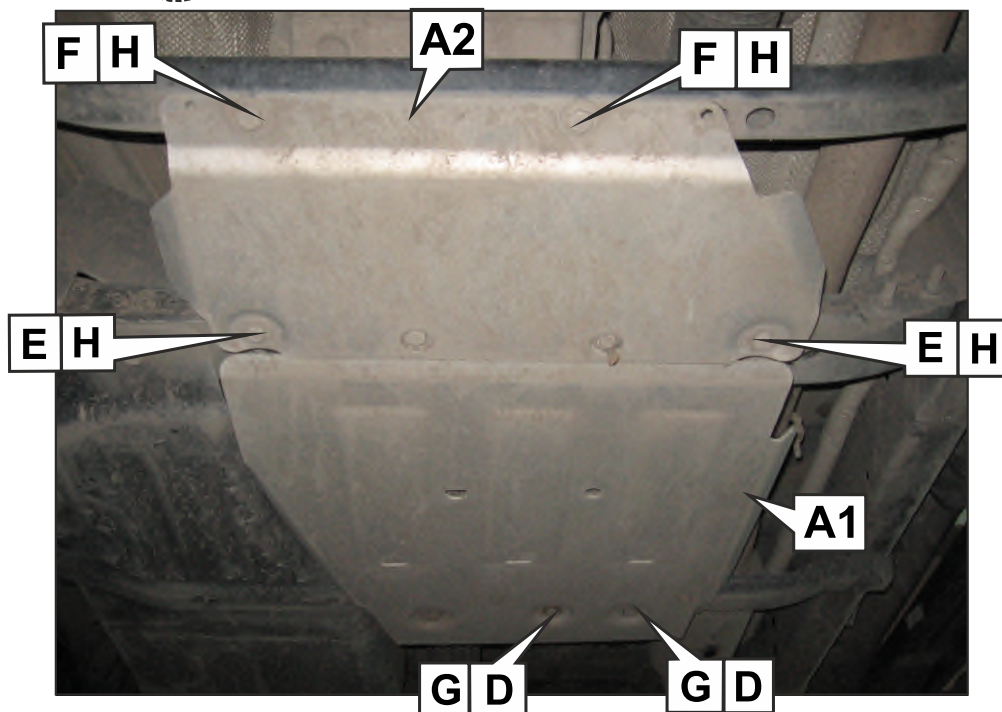
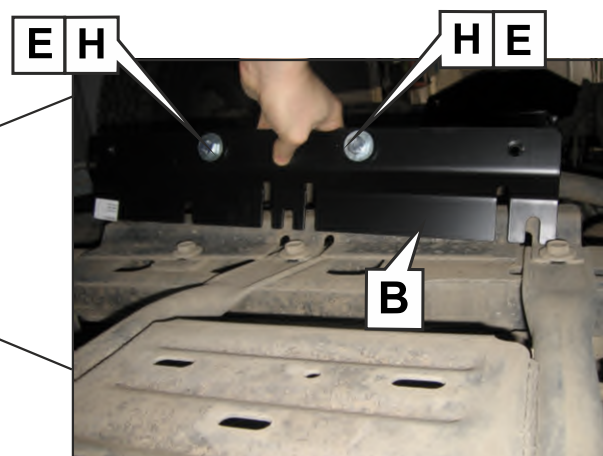
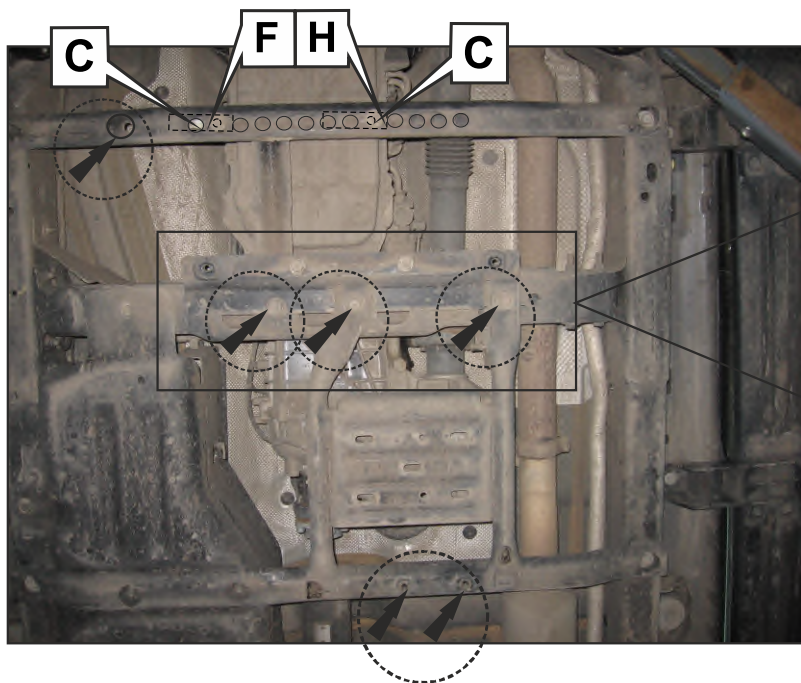

Engine bay and transmission elements skid plate has been designed and manufactured by LLC Metalloproduksia. Product conforms to TOR 4591-001-25888788-2006 requirements. Product design is protected by model copyright certificates №89059, 15980, 15981, 15982, 15983. Patented in Russian Federation.

INSTALLATION:

Engine bay and transmission elements skid plate has been designed particularly for a certain vehicle. It should be mounted according to the producer's installation instruction by a dedicated dealer or on certified service stations. The skid plate is fixed to regular apertures located on vehicle's body load-bearing elements. In case of correct installation the skid plate should not interfere with any vehicle's units and components.

OPERATING CONDITIONS:

Engine bay and transmission elements skid plate has been designed to operate in conditions specified by vehicle's producer. Cases of crush or driving into obstacles at a speed should be excluded during exploitation. In case of head-on crush it is necessary to assure in absence of damages of vehicle's components and units and availability of roadworthiness on certified service stations.

WARRANTY:

Warranty period - 12 months.

WARRANTY TERMS:

The skid plate should be installed on a vehicle with undamaged body and load-bearing elements (vehicle, which has never been involved in road traffic accident);

There are no mechanical damages of the skid plate resulting from head-on crush. All requirements to skid plate installation should be satisfied;

There are no mechanical damages of powder coating.

Producer does not bear liability for damages caused to the vehicle, health and life of people in case of installation and exploitation terms violation. Producer has a right to introduce changes into the skid plate construction.

ENVIRONMENTAL PROTECTION

Dispose of packaging properly. It is recommended to take it for recycling. Don't forget about environmental protection.

